



Year 8 Information Evening

Wednesday 18<sup>th</sup> September



# MAIDEN ERLEGH

## SCHOOL IN READING

Year 8 Parents' Information Evening

Wednesday 18th September  
2024

# Autumn Term

## MUSIC

In music, GCSE students have been preparing performances in lessons. Students are able to perform on a range of instruments, and performances have been as diverse as voice, piano, guitar, clarinet and drum kit.



# WARNER BROS STUDIO TOURS LONDON - HARRY POTTER



# LANGUAGES WEEK GUEST SPEAKER: Steve Eadon

Steve used to work for Arsenal FC in their Outreach team using languages every day for his job.



## MET CAREERS FAIR





## **CLIMATE CONFERENCE 2023**

8 of our students attended the InterClimate Reading Model Climate Conference 2023, representing the country of Uganda and the European.



## **CYBER GIRLS**

Our year 8 girls entered CyberFirst Girls Competition, run by GCHQ's National Cyber Security Centre.

## YEAR 9 DRAMA LIGHTING AND SOUND WORKSHOP

Students were lucky enough to have a workshop with a professional actor. A fantastic morning with one of the leading actors who starred in 'It's a wonderful life'.



## CHRISTMAS CONCERT



# Spring Term



Year 9's and 10's were looking into the history of the universe, working in groups to create timelines of the universe from the beginning until now as well as individually creating a small timeline of their own lives.



# DESIGN & TECHNOLOGY



## EDUCATIONAL INTERVENTIONS

We have had some brilliant visiting assemblies around Drug Exploitation Awareness from Storyy Group and Alcohol Awareness from Smashed Live.



## SKI TRIP

Students from MER took the plunge of spending a week away from home, skiing in Italy.

## 'BOOK BIN' EVENT FOR WORLD BOOK DAY!

Over two mornings, our enthusiastic readers were encouraged to take away a book for free from the 'bin'.



6 students presented their posters and PowerPoint presentations as part of the Maiden Erlegh Independent Project, run by Mr Tomsett.



# Summer Term



Disney  
*Aladdin*  
JR. ©Disney



# FAREWELL TO YEAR 11



## **ATHLETICS**

23 of our students from years 8, 9 and 10 were selected to compete in the Reading town championship.



## **MENTAL HEALTH AWARENESS WEEK**

To celebrate Mental Health Awareness Week we had a variety of different *Do Now* activities in all lessons to build awareness within our community.

# SPORTS DAY - A GREAT SUCCESS



Under  
the Stars  
PROM 2024  
MAIDEN ERLLEGH SCHOOL IN READING



# CULTURAL DIVERSITY FAIR





**Ofsted**  
Good  
Provider

**MAIDEN ERLEGH**  
SCHOOL IN READING  
**PROUD TO BE RATED GOOD**  
We are delighted that Ofsted have rated Maiden Erlegh School in Reading as a 'Good' school.

**Ofsted**  
Good  
Provider

**MAIDEN ERLEGH**  
SCHOOL IN READING  
**PROUD TO BE RATED GOOD**  
We are delighted that Ofsted have rated Maiden Erlegh School in Reading as a 'Good' school.



Aim High



Be Inclusive



Work Together

# Attendance Matters!



**MAIDEN ERLEGH**  
SCHOOL IN READING

- Year 11 GCSE results 2024
- Students with less than 90% attendance across the year achieved over 4 grades less (on average) than students whose attendance was above 90%

“

Success is no accident. It is hard work, perseverance, learning, studying, sacrifice and most of all, love of what you are doing or learning to do.

PELE

GRACIOUSQUOTES.COM



MAIDEN ERLEGH  
SCHOOL IN READING

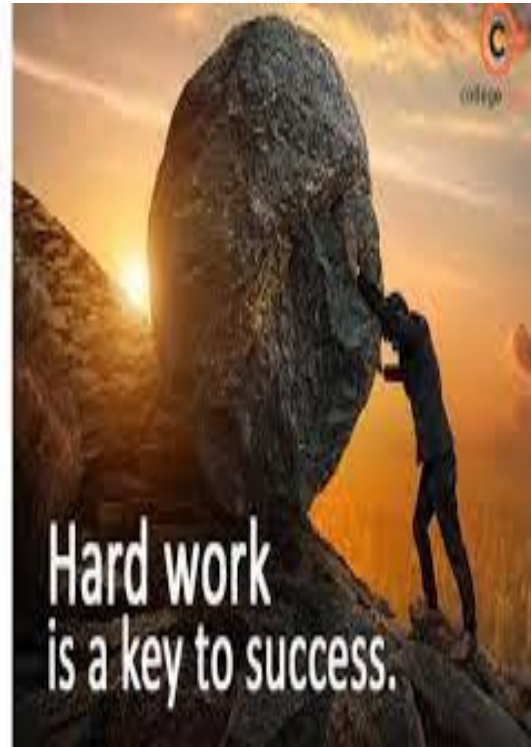

# Your Attitude to Learning is key to your success



Working to  
improve  
something is  
better than crying  
about how bad  
things are.



A journey of a thousand miles starts  
with a single step



**Aim High**

**Work Hard**

**Be Kind**

# Parents– We need You!



**MAIDEN ERLEGH**  
SCHOOL IN READING



 **MAIDEN ERLEGH**  
SCHOOL IN READING

## School Street Scheme

### VOLUNTEERS NEEDED

We have been in communication with Reading Borough Council regarding a proposed trial of a 'School Street' scheme to make it easier and safer for children to walk and cycle to the schools in the Crescent Road area.

Under this scheme, the area of **Crescent Road** between **Wokingham Road** and **Bulmershe Road** would temporarily become a **pedestrian and cycle only zone** for 45 minutes at the beginning and end of the day.

We are proposing that the closure times would be:

**8.15 – 9.00am and  
2.45 – 3.30pm  
Monday to Friday term time only.**

We are therefore looking for volunteers from the local community to marshal the road between these times.

If you feel you are able to help please email [MERoffice@maidenerleghtrust.org](mailto:MERoffice@maidenerleghtrust.org)

For further information about the scheme please visit [www.maidenerleghschoolreading.co.uk](http://www.maidenerleghschoolreading.co.uk) or [www.reading.gov.uk](http://www.reading.gov.uk)

Maiden Erlegh School in Reading  
81 Crescent Road, Reading, RG1 5SL Tel: 0118 9668065



MAIDEN ERLEGH  
SCHOOL IN READING

# Welcome

## Mr Carpenter – Head of Year 8

‘Continuing our great start’





TM

PARIS 2024

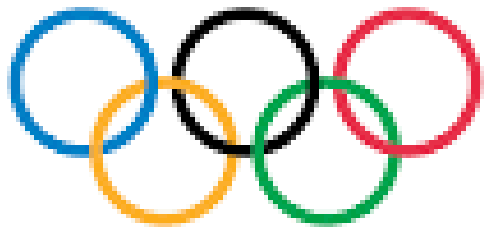

# Reminder: Year 7 Parents' Dreams for their children

“ To realise she is smart and to do her very best”

“ That my son will be given the support and direction that he desires”

“ Enjoy and seek learning. Meet and interact with people from diverse backgrounds and beliefs. Find their calling- do something they like and apply themselves”

“ She loves to sing but she's very shy, maybe she will change in secondary. I do really love to listen to her, but she can be whatever she wants to be.”

“ Doctor”



**MAIDEN ERLEGH**  
SCHOOL IN READING

# Key Staff

- Mr Graham – Headteacher
- Mrs Harvey – Assistant Headteacher – Behaviour & Culture
- Miss Davies – Assistant Headteacher – Safeguarding
- Ms Benham – SENCO
- Mr Carpenter – Head of Year 8

# Meet the tutors

- HoY – Mr Carpenter
- 8G1 – Miss Thompson
- 8G2 – Mr Greener
- 8P1 – Mrs Moore
- 8P2 – Mrs Hurd-Rhooms/Mr Butchers
- 8T1 – Mr Abiola/ Mr Butchers
- 8T2 – Mrs Vacy-Ash



**MAIDEN ERLEGH**  
SCHOOL IN READING

# What kind of school are we?

A school of Opportunity, Diversity and Success

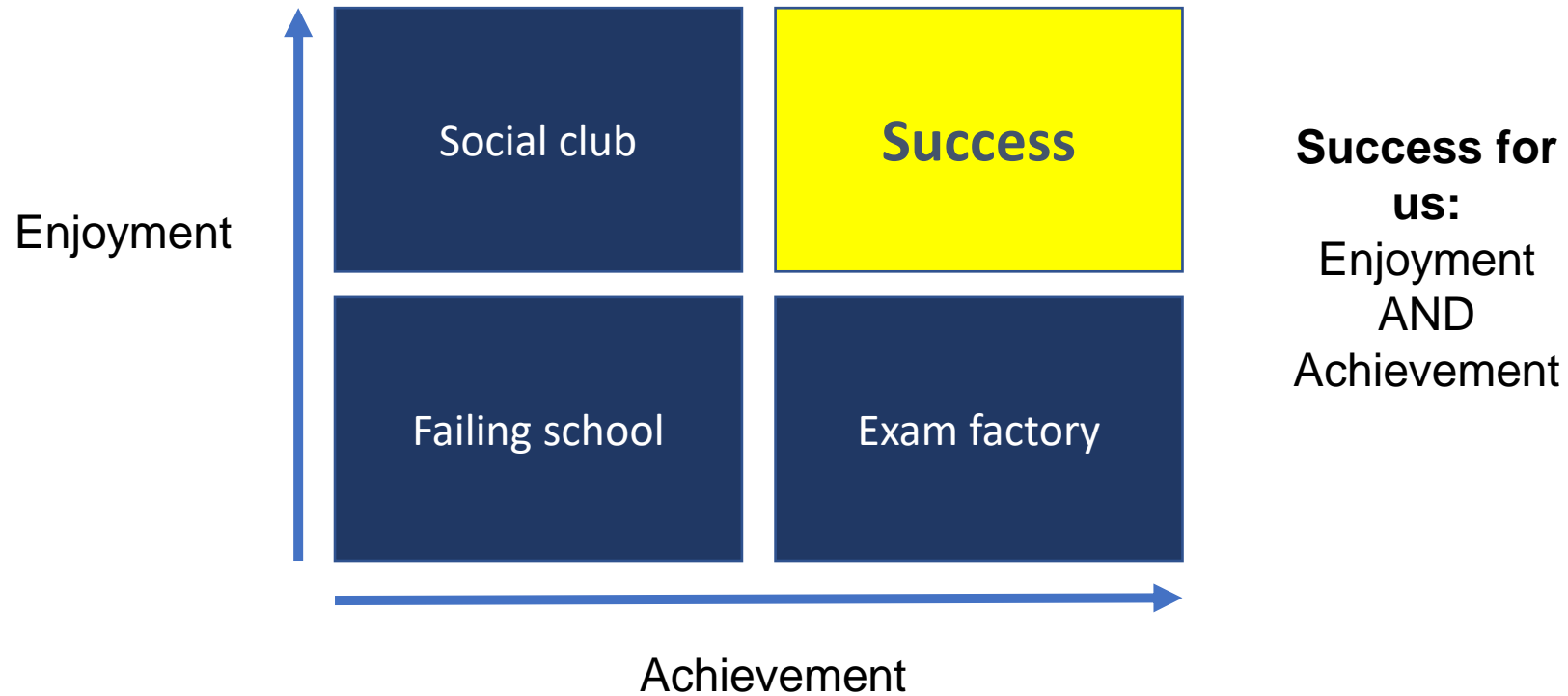

# What do our students say about us?



MAIDEN ERLEGH  
SCHOOL IN READING

“Things I like about MER... There are a lot of encouraging students from years 8, 9, 10, 11 and 7”

“My favourite thing about MER is the way we get to be independent.”

“I like the positive environment”

“The students are really kind and helpful, a y11 helped me find my class.”

“The best thing about year 7 is that you are taught new things.”

“The teachers are really kind and caring”

“It has lots of opportunities for us and it makes me excited for what is next..”

“The school is tidy and clean, and the teachers are kind”

“The rules are fair”

# How do we educate your child?

- A broad and balanced curriculum

- A modern approach that goes beyond the minimum.

Traditional subjects  
Activities, clubs and societies

Literacy

Numeracy

Spiritual, Moral,  
Social & Cultural

Pastoral  
Programme

Personal Growth

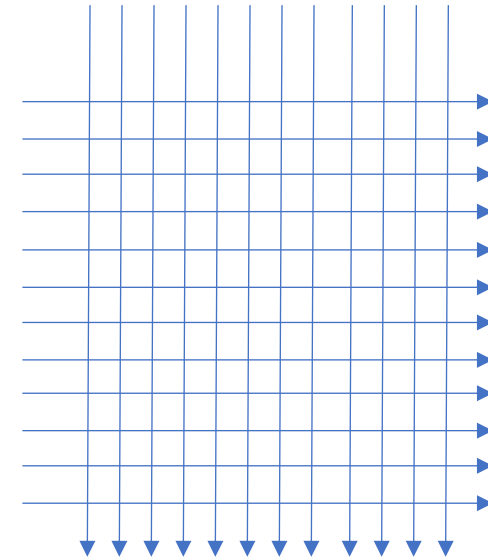

# A wide range of subjects

- Maths
- English
- Science
- History
- Geography
- French
- Spanish
- PE
- Drama
- Art
- Music
- Food tech
- Design technology
- Computing
- Personal Development



**MAIDEN ERLEGH**  
SCHOOL IN READING

# How do we ensure your child is making progress?

---

Experienced, highly qualified staff

---

Teaching students to reflect and improve and take responsibility to progress

---

Regular assessment (with regular feedback to parents)

---

Identifying areas for improvement

---

Support where necessary





# How can you help?

- From experience we know that we must work together so that every child's learning is secure.
- We want parents and carers to be actively involved in school life, helping to enrich the experience of the students.
- Planning for the day ahead – Organisation is the key.
- Open communication.
- Supporting with Homework.

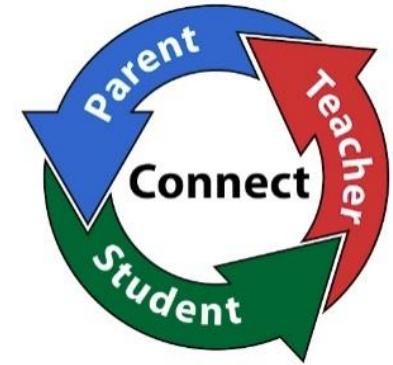



Teacher /parent contact

- Phone calls
- Progress meetings

Google  
Classroom



Student messages

ClassCharts – info to follow!



How do we  
communicate  
with you?

Website:

[www.maidenerleghschoolreading.co.uk](http://www.maidenerleghschoolreading.co.uk)



Twitter/X: @MESReading

# Plan ahead: Seating Plans and effective behaviour management will help keep pupils and staff safe

Save teachers time & reduce workload with our data rich seating plans. Improve pupil behaviour with our fast and effective behaviour management.

I'M A SECONDARY SCHOOL

I'M A PRIMARY SCHOOL



## Log in

Teacher

Parent

Student

Enter your email:

[?]

Email address

Confirm your email:

Retype your email address

I already have an account

I don't have an account yet

Parent access code (supplied by school):

Access code

Your name:

Your name

Choose password:

Choose password



[What makes a strong password?](#)

Retype chosen password:

Retype chosen password



By clicking the Log in button, you agree to our [Privacy Policy](#)

Remember me

Log in

## Class Charts Parents

### I don't have a code

I am sorry but we cannot help with this and you will need to ask your school to provide you with a new code

### I cannot log in

Please check you are using the correct email address. If you have forgotten your password then you can use the password reset feature.

### I still need help

For security reasons we are unable to help with parent accounts, please contact your school for help with your account.

### Quick Start Parents guide

For additional information about Class Charts, please check out our Quick Start guide for parents. [Click here](#)

# Extra-curricular Activities



MAIDEN ERLEGH  
SCHOOL IN READING

## MONDAY

WHAT	WHEN	WHERE	WHO
KS3 Art Club	3.15pm – 4.15pm	207	Y7, 8 & 9
Reading Rockets Basketball	3.15pm – 4.00pm	Sports Hall	Y10 & Y11
GCSE PE Booster	3.15pm – 4.15pm		Y10 & Y11
Homework Club	3.15pm - 4.00pm	21B	All welcome

## TUESDAY

School Band	3.15pm – 4.00pm	044	All welcome
Open Access Art GCSE	3.15pm – 4.30pm	206/207	KS4 Art Students
History Revision Club	3.15pm – 4.00pm	205	KS4 History Students
Chess Club	3.15pm – 4.00pm	112	All welcome
Maths GCSE exam prep	3.15pm – 4.00pm	118	Y10 & Y11
KS3 Maths Homework Club	3.15pm – 4.00pm	119	Y7, 8 & 9
Girls football Year 7	3.15pm – 4.15pm	Field	Y7
Rugby Year 7	3.15pm – 4.15pm	Field	Y7
Badminton	3.15pm – 4.15pm	Sports Hall	Y10 & Y11
Boys Football Year 7	3.15pm - 4.15pm	Field	Y7





# Attendance Procedures

- **Reporting your child's absence**

This needs to be done by 9am each morning. You can report an absence via the following;

- Via Classcharts – select the "absences" tab and "report new absence"
- Attendance Line – 01189 668 065 select the option to report your child's absence.
- Email – [merattendance@maidenerleghtrust.org](mailto:merattendance@maidenerleghtrust.org)

**Please state the child's name, tutor group and a detailed reason for absence in the voicemail/email.**

If your child is absent and you do not communicate this to us, you will receive a text message asking for a reason for the unexplained absence.

- **Requesting leave for medical appointments**

We ask that all medical appointments are booked outside of school hours where possible. We do understand that may not always be the case. Please send an email to [merattendance@maidenerleghtrust.org](mailto:merattendance@maidenerleghtrust.org) with the evidence of medical appointment (email of appointment or photo of letter) at least 24hrs before the day of the appointment.

# Attendance Matters - MER Traffic Lights of Concern



MAIDEN ERLEGH  
SCHOOL IN READING

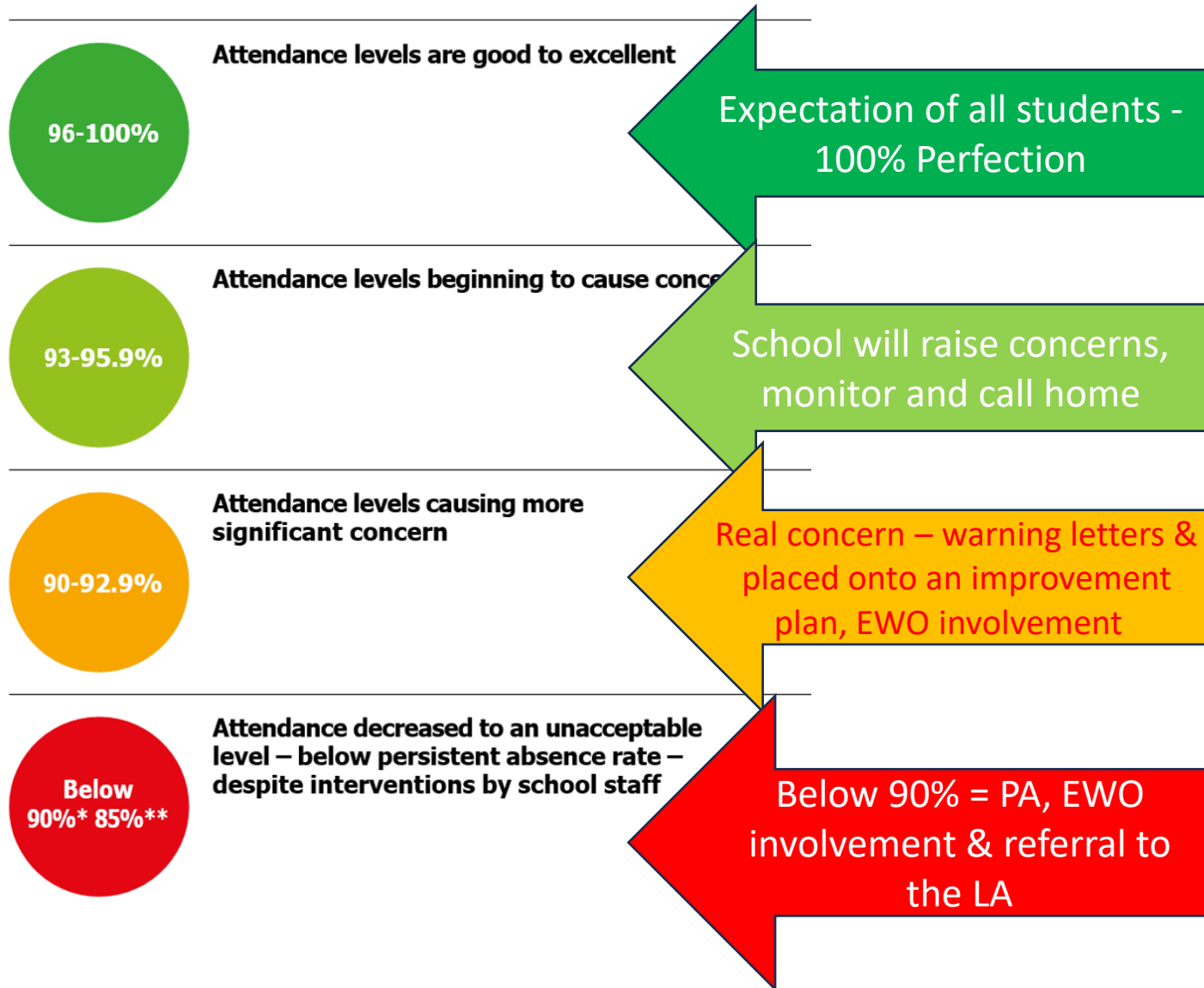



# Why it matters – lateness = lost learning



Lost Learning  
=  
Reduction in  
Achievement &  
Wellbeing



# Lateness to School

- Students who are **NOT** past the school gates by **8:38** are **LATE TO SCHOOL** - these students will be asked to attend a **late to school detention** that day at breaktime in 114
- **What happens at the gate?**
  - Students will be met by a member of staff who will record students' arrival and give them a slip for – it will also remind them of the late to school detention in 114
- **What happens in detention?**
  - Students will have an opportunity to speak to staff, seek support where necessary and understand why being on time matters
- **What happens if I forget or don't make it?**
  - This detention will be escalated to lunchtime the same day
- **What if I have made it past the gates and onto school site by 8:40 but I arrive in tutor a minute late?**
  - You are to follow the late to lesson process, a late mark will be recorded in the register along with the number of minutes late you are – the lateness time will count against your lateness to lessons that day



# New Morning Routine – Line Ups

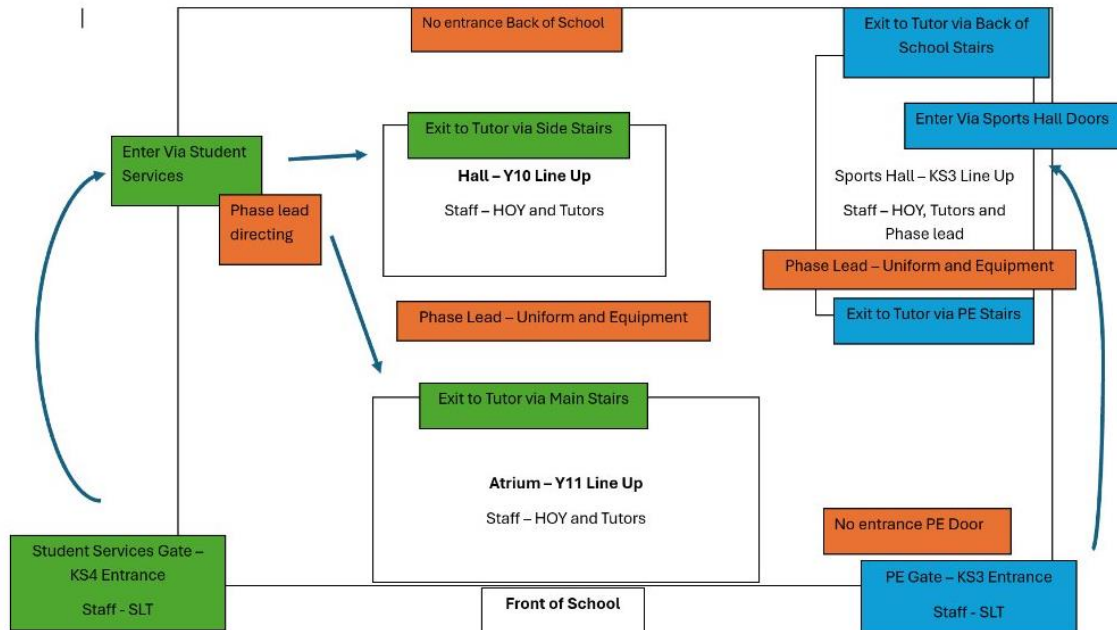



# Line ups



Students to enter the Sports Hall once the school gates are open



Students to line up in correct uniform (including lanyards) in alphabetical order in tutor groups



This allows HOY's and Senior leaders to give key messages to all students and ensure uniform and routines are followed

# Uniform Check

- Blazer
- Shirt – Tucked in
- Tie
- Lanyard
- Trousers/Skirt
- School Shoes – No trainers
- Stud earrings only



# Year 8 Lanyards and MER Passports

	<b>AMon</b>	<b>ATue</b>	<b>AWed</b>	<b>AThu</b>	<b>AFri</b>
<b>1</b>	Science MSH C8	English LBL B17	Design Tec SJ A3	English IBA C15	Geography OM B26
<b>2</b>	Pe Male SSH SPH	Design Tec SJ A3	Support MV	L@KES PAB A10	Drama CP B20
<b>3</b>	Geography OM B26	Support MV	Science MSH C8	Music ST A11	Accel Reader PCO LIB
<b>4</b>	Computing MR B6	Maths KN B9	Maths KN B9	Maths KN B9	Science MSH C7
<b>5</b>	Art TR A8	Pe Male SSH SPH	English PB B17	Support MV	Maths KN B9



# Equipment Check

Pen



Pencil



Ruler

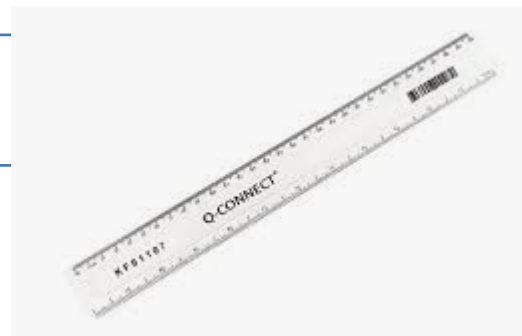

Rubber

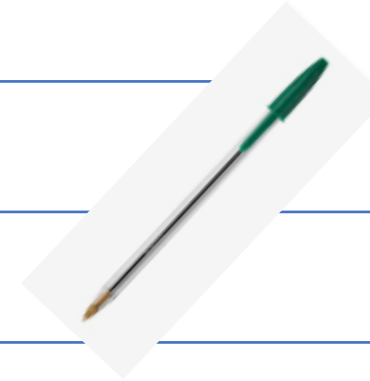

Calculator

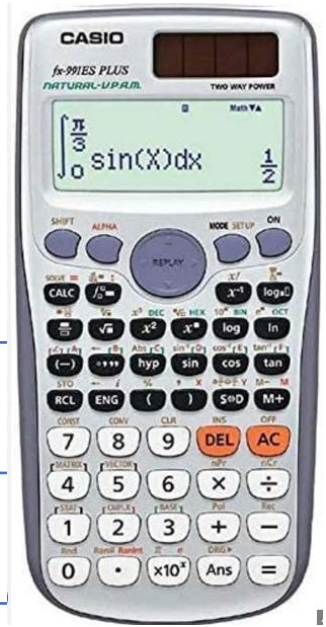

Green Pen



Highlighters



# The School Day

Change for  
YEAR 8 =  
SNACK 2

Line-up – Sports Hall 8:40

Tutor – 8:40 – 9:05

Lesson 1 – 9:10 – 10:10

Lesson 2 – 10:15 – 11:15

Break – 11:15 – 11:30

Lesson 3 – 11:35 – 12:35

Lesson 4 – 12:40 – 13:40

Lunch – Snack 2 – 13:40 – 14:05

Lesson 5 – 14:10 – 15:10

# THE MER WAY



Ready

Safe

Respect

# THE MER DREAM

---

## THE MER DREAM



### DETERMINATION

- Showing **determination** in all we do
- Showing resilience – **Never giving up**
- **Working hard** at every opportunity



### RESPECT

- Showing **good manners** and **being polite**
- Showing the commitment to act as a **positive member** of the community
- **Caring** about others and our environment



### EXCELLENCE

- Showing **ambition** - Reaching for the stars and having sky-high expectations
- **Taking pride** in our work
- Striving for **excellence** in everything we do



### ATTITUDE FOR SUCCESS

- Consistently **ready** and showing a **passion for learning**
- Being able to **problem solve** and be an **independent learner**
- Being **motivated** and **curious** about our learning



### MATURITY

# Rewards



MAIDEN ERLEIGH  
SCHOOL IN READING

- Dream points
- Tutee of the week
- Golden tickets
- Postcards home
- HOY award
- Pizza parties



# ParentPay



MAIDEN ERLEGH  
SCHOOL IN READING

- “Cashless school”
- Payments for school lunches/ trips/ equipment etc.
- Please note, the parentpay shop is where you can purchase lockers. The link can be found on our school website.



# In School Support

- Tutor
- Head of Year
- SENCO (including TA's)
- Inclusion Team (Behaviour/SEMH/ ELSA support/ other concerns)
- Breakfast Club
- Homework Club
  
- External Agencies when applicable



**MAIDEN ERLEGH**  
SCHOOL IN READING

# Who do I speak to if I need support?

- Tutor – can help in the first instance or point you in the right direction
- Curriculum Leader/ Head of Year 8
- Phase Leaders
- Safeguarding – Assistant Headteacher, Miss Davies



**MAIDEN ERLEGH**  
SCHOOL IN READING

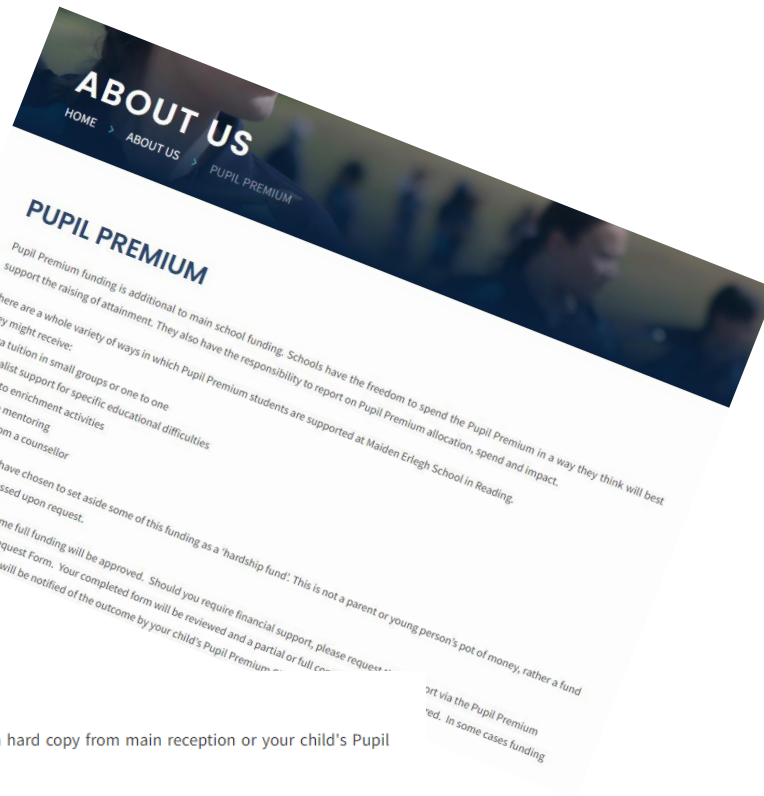

#### PUPIL PREMIUM CORRESPONDENCE

Our Pupil Premium Financial Support Request form is listed below and also available as a hard copy from main reception or your child's Pupil Premium Champion.

If you believe you should have Free School Meals, please click [here](#) for more information

BERKSHIRE MAESTROS PUPIL PREMIUM FINANCIAL SUPPORT REQUEST FORM

PDF FILE

PUPIL PREMIUM FINANCIAL SUPPORT REQUEST FORM

PDF FILE

Support with contributions towards uniform, accessing education e.g. food tech practicals, trips etc.

# Wrap Around Support

- Breakfast Club & Homework Club
- Breakfast Club £35 per term – includes food and drink. 8.00 start.
- School may be able to help support financially upon request if entitled to Pupil Premium support
- Homework Club on Monday to Thursday every week until 3:55pm
- Other extra-curricular clubs available until 4:15  
**(They're free!)**



**MAIDEN ERLEGH**  
SCHOOL IN READING

LEARNING

# WALKTHRU<sub>s</sub>

BETTER LEARNING, STEP BY STEP



SUPPORTING YOUR CHILD'S LEARNING